



## MOBILE TRAILER OPERATING AND MAINTENANCE MANUAL

### 1. GENERAL

This operating and maintenance manual is designed to help you in the safe and long-term operation of our mobile trailer. Please read this manual before using the mobile trailer and follow the requirements, as compliance with the requirements is the basis for our mobile trailer's one-year warranty.

All trailers manufactured by us are EC type-approved and comply with the requirements of the EC directives in force at the time of manufacture.

### 2. COUPLING THE MOBILE TRAILER

Attach the safety cable of the mobile trailer to the coupling hook of the towing vehicle and check its condition. Lift the coupling device of the trailer onto the ball mount of the towing vehicle and push it down until the coupling device locks into place with an audible click. When lifting, consider the weight of the trailer to avoid any potential injuries. The green status indicator on the coupling device of the mobile trailer indicates that the trailer coupling is firmly locked (+ position shown in Figure 1).

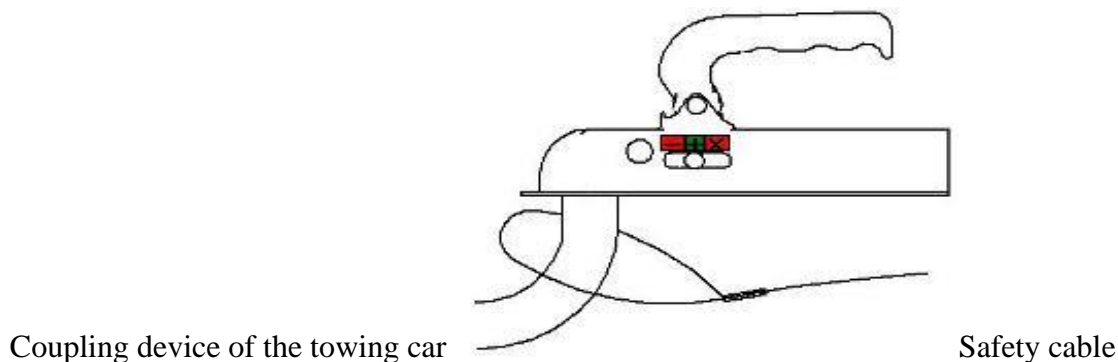

Figure 1: locked coupling device.

**ATTENTION:** If the trailer coupling device does not lock in the position shown in Figure 1, determine the cause and do not start driving; it is prohibited! The explanations for coupling device status indicators are shown in Section 2.1.

When uncoupling the mobile trailer, follow steps described in paragraph 3.

When the coupling device is properly locked, use the crank 1 to turn the support wheel 2 into the prescribed position (Figure 2), i.e. into the groove (Frame A in Figure 2), which fixes the wheel position parallel to the driving direction and prevents spontaneous loosening. Then, open the support wheel clamp 3 and lift the support wheel to the upper position as shown in Figure 2. When the support wheel is in the upper position, close the clamp to prevent the support wheel from dropping.

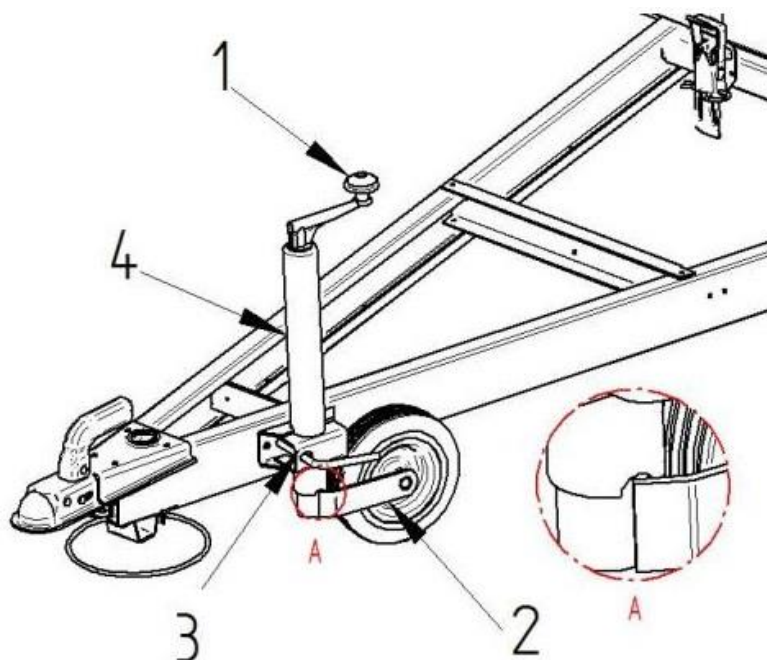
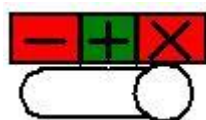

Figure 2: support wheel fixed in the upper position.

Plug the power cable of the mobile trailer into the power socket of the towing vehicle and before driving check if the trailer lights are in proper operating condition. Before plugging in the power cable, make sure that both the plug and the socket are clean.

**ATTENTION:** Do not start driving in case trailer lights fail to operate in the prescribed mode!

### 2.1. Coupling device status indicators



Red 'x' position indicates that the coupling device is unsecured.



Green '+' position indicates that the coupling device is secured, sits correctly on the ball mount; driving is allowed.

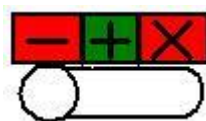

Red '-' position indicates that the coupling device is not properly secured; driving is prohibited. The coupling device is not locked onto the ball mount or the coupling device and/or the ball mount is too worn.

**ATTENTION:** Intermediate positions of the coupling device between – or + and + or x are not allowed; these positions indicate that the coupling device or the ball mount is too worn; driving is prohibited!

### 3. UNCOUPLING AND PARKING THE MOBILE TRAILER

To uncouple the mobile trailer:

- Loosen the support wheel clutch and lower the support wheel to the ground. Fix the position of the support wheel with a clutch (see Figure 2). The support wheel should be levelled in such a way to ensure that the trailer is horizontal;
- Press on the safety catch of the coupling device, pull the handle up, and then move in the direction 2 shown in Figure 3 until the device is uncoupled and released from the ball mount. Lift the coupling device slightly away from the ball mount, paying attention to the trailer weight – avoid potential injuries;

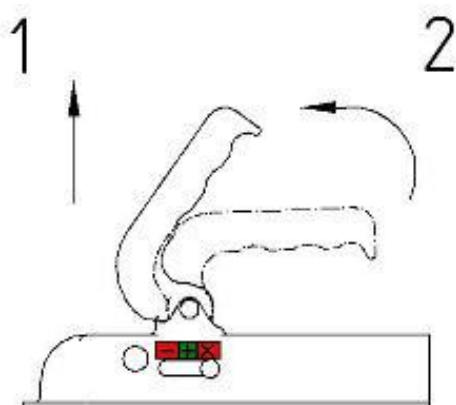

Figure 3: uncoupling the coupling device.

- Remove the mobile trailer safety cable from the ball mount of the towing vehicle;
- Remove the trailer's power cable from the power socket of the towing car and place it in the socket holder of the mobile trailer;
- Choose a flat, hard, non-slippery ground for parking the trailer; be sure not to stop or park the trailer on a slope or on smooth ground with soft substrate;
- Once a stationary location for the mobile trailer has been found, be sure to mount support legs and wheel chocks, and move the parking brake into braking position;
- The mobile trailer must be positioned as horizontally as possible to prevent the spontaneous movement of open doors and windows, or the entry of water or snow accumulated at the edges of doors and windows into the trailer.

**ATTENTION:** It is prohibited to operate or enter the mobile trailer before mounting the support legs, wheel chocks, and moving the parking brake into parking position!

#### 4. LOADING THE MOBILE TRAILER

The maximum permissible gross vehicle weight and unladen weight of the trailer are indicated on the trailer registration certificate. The payload of the trailer is calculated as the difference between gross weight and unladen weight.

**ATTENTION:** Overloading the trailer is prohibited – it can cause traffic hazard, premature wear, and the bending and breaking of parts of the trailer! We draw attention to the fact that the user's lack of knowledge of the weight of the load does not exonerate them from the responsibilities arising from possible consequences of overloading.

Trailer damage indicative of overloading is not covered by the warranty, regardless of whether it was caused during driving or while stationary.

The term 'load' also includes all the reservoirs (water, toilet, etc.), which must be closed, secured, and emptied before driving.

The load must be spread as evenly as possible and secured to the trailer so that:

- it will not cause damage to the trailer or its interior and devices during driving;
- it does not affect the steerability of the trailer and thereby avoiding any hazardous situations;
- it prevents uneven wear and tear of tyres and wheel bearings but also other damage.

Positioning the load only to the rear of the trailer is prohibited, as it will cause the towing hook of the vehicle to raise, resulting in the coupled combination becoming very unstable when driving.

To ensure better road stability, the maximum coupling device load requirements must be followed, with vertical load up to 10% of gross weight but not above the value indicated on the coupling device.

**ATTENTION:** Mobile trailers are not intended for use as a load transporting truck! Pay attention to the allowed load capacity!

#### 5. BEFORE DRIVING

Before driving, check the following:

- the condition of the coupling device (see Figure 1 and Section 2.1). It is important to ensure that the height of the towing hook of the towing vehicle is within range of  $430 \pm 35$  mm according to standard DIN 74058;
- the secure coupling of the trailer and the towing vehicle; there should be no gap, and the ball mount of the vehicle should be completely inside the coupling device (see section 2.1);
- that the safety cable of the trailer is mounted on the coupling hook and that the safety cable is in good working condition;

- that the power plug of the trailer is connected to the towing vehicle and that all trailer lights are working properly;
- the condition of trailer tyres, tyre pressure, and proper wheel attachment;
- that the removable and securable parts of the trailer (including support legs and wheel chocks) are safely secured or removed;
- that the parking brake of the trailer is released;
- that the support wheel is raised to the upper position, the support wheel must be parallel to the direction of driving;
- that the doors and windows of the trailer are properly locked. Driving with unlocked doors and windows is prohibited; it can lead to hazardous situations!
- double check that the trailer is not overloaded (see Section 4) and that no one is inside.

## 6. TRAVELING WITH A MOBILE TRAILER

When traveling with a mobile trailer, you must follow the traffic regulations of the country of location; be sure to familiarise yourself with the regulations before driving. Driving permissions and requirements for traveling with a mobile trailer may vary from country to country. Driving with a trailer is only permitted to persons in possession of relevant authorisation.

**ATTENTION:** When reversing the trailer, make sure there are no people behind it and that there is enough room for reversing! During reversing, the trailer revolves around the towing vehicle's ball mount; therefore, the steering wheel must be steered in the direction opposite to the intended driving direction. Take wide turns at curves and reserve a longer drive-up distance when changing lanes. Keep in mind that steering might be affected by wind when towing a mobile trailer with greater lateral area.

**ATTENTION:** The mobile trailer is not intended for driving on hilly, bumpy and uneven terrains, and in difficult road conditions (strong winds or snow and rain), in thick mud, on soft surfaces, in snow, and in water.

## 7. MAINTENANCE AND SERVICING

### 7.1. General maintenance and servicing

To ensure the good technical condition of the mobile trailer it must be regularly serviced in accordance with the manufacturer's instructions.

*The packaging (plastic foil) used during transportation must be removed immediately if the mobile trailer is stored outdoors.*

After the first 500 km check all the fastenings of windows and doors, make sure that all screw fittings, incl. wheel bolts are tight; if necessary, tighten them. The normal tightening torque for the wheel bolt is 100–120 Nm.

To extend the service life of tyres, proper tyre pressure must be maintained in the tyres. In the event of rapid, uneven and premature wear of tyres, check axle alignment and tyre pressure. The regulations for tyres vary from country to country, but as a rule, towing vehicle and the mobile trailer must have the same type of tyres. Contact your dealer for details.

The dimensions and load index of trailer tyres and wheels must conform to the parameters prescribed by the manufacturer (check registration certificate). The minimum tyre tread depth for summer and winter tyres must conform to requirements of the country of location. Contact your dealer for details.

The mobile trailer is equipped with zero-maintenance wheel bearings. If the bearing is worn or damaged, it must be replaced immediately and the cause of the damage should be identified. In most cases, this is due to uneven loading of the trailer. Contact your dealer for details.

The owner is obligated to perform initial maintenance with the manufacturer or their authorised representative at the latest one year after the purchase of the trailer or after 10,000 km. In the future, periodic maintenance should be carried out at least every 10,000 km.

The mobile trailer must be kept clean; it should be washed regularly, similarly to a car; standard car wash detergent is also suitable for washing the trailer. The trailer must always be washed immediately after driving on salted roads, as de-icing salt and other substances used in road maintenance may cause irreversible damage to the outer surface of the trailer, especially to zinc-coated and galvanised materials.

Under winter conditions, the roof of a trailer that is immobile for an extended period, should be cleared of accumulated snow thicker than 10 cm. This prevents damage to the roof and walls caused by excessive load.

To prevent the doors and windows from freezing, their seals must be regularly smeared with special silicone. Door lock must be cleaned and oiled once in four months.

The braking system of the trailer requires continuous maintenance and proper adjustment; therefore, we recommend having this performed by the manufacturer or their authorised representative. Contact your dealer for details.

To reduce the wear of the ball mount and the mounting device, smear regularly with weatherproof lubricant in the areas shown in Figure 4. This action should also be performed whenever the coupling device is not functioning seamlessly.

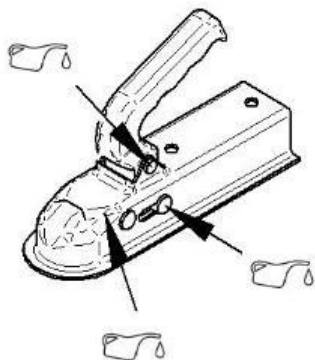

Figure 4: coupling device areas requiring lubrication.

**Attention:** Do not carry out flammable work in the mobile trailer, as it will damage the interior and may result in a fire hazard.

Zinc-coated components of the new mobile trailer are initially shiny, but over time, they fade as zinc reacts with oxygen in the air. This is the normal oxidation process that renders the zinc layer making it even more resistant to corrosion.

## 7.2 Maintenance and servicing of the gas installation

If your mobile trailer is fitted with a gas appliance, it should be inspected periodically by a specialist and serviced annually. Under no circumstances attempt to perform gas works by yourself. For more information see the operating and maintenance instructions of your specific appliance. The owner is responsible for ensuring that the requirements for the gas appliance are followed and that it can be used safely.

Upon discovering a gas leak or smelling gas:

- evacuate people from the trailer and move them to safe distance;
- immediately close the gas supply;
- turn off the trailer's power supply;
- ventilate the trailer by opening windows and doors;
- do not smoke or use electricity inside the trailer
- inform other people of danger, and in the event of higher risk, inform the alarm centre.

After the elimination of the gas system failure be sure to inform the manufacturer via the dealer.

## 7.3 Maintenance and servicing of the electrical installation

Inspections and repairs to the electrical system of a mobile trailer with a switchboard may be performed only by a competent specialist. Under no circumstances attempt to perform

electrical works by yourself. Electrical instructions (attached to the switchboard) must be followed when connecting mobile trailer with a switchboard to a 220 V external network.

Strictly follow the manuals of electrical appliances (heaters, refrigerators, etc.) in order to avoid damaging the appliances and/ or the whole electrical system of the trailer. Only plug in electrical appliances that are permitted according to the electrical wiring diagram of the trailer. Other appliances may cause overload in the electrical system and damage the towing vehicle as well as the power supply.

*Do not leave plugged in electrical devices unattended.*

To prevent mechanical damage and malfunction of the vehicle or the electrical system of the trailer, check the integrity of the plug of the trailer's electrical system and the socket of the towing vehicle each time before connecting them.

The connector pins and caps of light bulbs in marker lamps can oxidise over time; therefore, they must be inspected regularly and cleaned when appropriate. We recommend having this performed by the manufacturer or their authorised representative.

#### **7.4 Maintenance and servicing of speciality mobile trailers**

In case of speciality trailers (such as: trailer for preparing fast food, toilet trailer, etc.) fire-safety and ventilation requirements must be followed in addition to the general maintenance and service requirements. The maintenance and repair of all technical appliances (electricity, gas, heating, water system and plumbing, etc.) must be done by a competent specialist. Under no circumstances attempt to perform these by yourself!

#### **7.5 Altering the mobile trailer, changing its appliances and interior**

Changes and alterations to the mobile trailer and to its appliances and interior need to be approved by the manufacturer in writing. Manufacturer will review the alteration proposal to make sure all technical and safety requirements for the mobile trailer are met.

The warranty for the trailer will terminate in case changes or alterations to the trailer or to its interior have been made without the approval from the manufacturer.

#### **7.5 Mobile trailer water system**

*The maximum allowed water pressure in the water supply line connected to the water system of the mobile facility is 6 bar. It is recommended to attach an informative sticker to the connection point of the mobile facility.*

### **8. WARRANTY**

The warranty period for mobile trailers is 1 year. The warranty period starts from the moment the trailer is transferred to the final consumer.

The purchaser must inform the dealership that sold them the mobile trailer of discovering a defect, for which they intend to make a claim, within 3 working days. The dealership must



be given the opportunity to check the alleged malfunction. If the defect is to be eliminated in the scope of the warranty, the dealership will provide the manufacturer with a written claim as agreed.

Warranty conditions for the mobile trailers of AS Respo Haagised can be seen on the website of AS Respo Trailers at [www.respo.ee](http://www.respo.ee).

We recommend that you insure the mobile trailer to reduce restoration costs in case of major damage (natural disasters, traffic accidents, interior decay, etc.).

The warranty is valid only if the owner complies with the requirements in this manual and if the mobile trailer undergoes regular maintenance.

### 9. MOBILE TRAILER LIFTING MECHANISM

*Lifting angle should be taken into account when choosing the appropriate lifting equipment for lifting mobile facilities equipped with lifting mechanism. The greater the angle, the stronger the lifting sling has to be. The maximum allowed lifting sling angle is 120°.*

